

GUNNING



29 Saunders Bay Road Caringbah South NSW

7 4 4

"Secure your private dual home executive estate in one of the finest waterway suburbs in Sydney."

Gunning Real Estate is proud to exclusively present this fine executive estate featuring two separate residences on a double sized block at Caringbah South.

Caringbah South is a highly desirable waterway and beachside suburb in southern Sydney located in the Sutherland Shire. The area provides an idyllic life style located beside the Port Hacking waterway, bays and beaches.

The two executive designed homes feature open plan living space flowing onto entertaining areas and private court yards. The estate design provides flexibility for many lifestyle situations with two fully self contained homes. This

Land Size : 1182 sqm
View : <https://www.gunningre.com.au/sale/nsw/sutherlandland/caringbah-south/residential/house/5731223>



William Gunning
(02) 9310 9207

**29 Saunders Bay Road,
CARINGBAH**

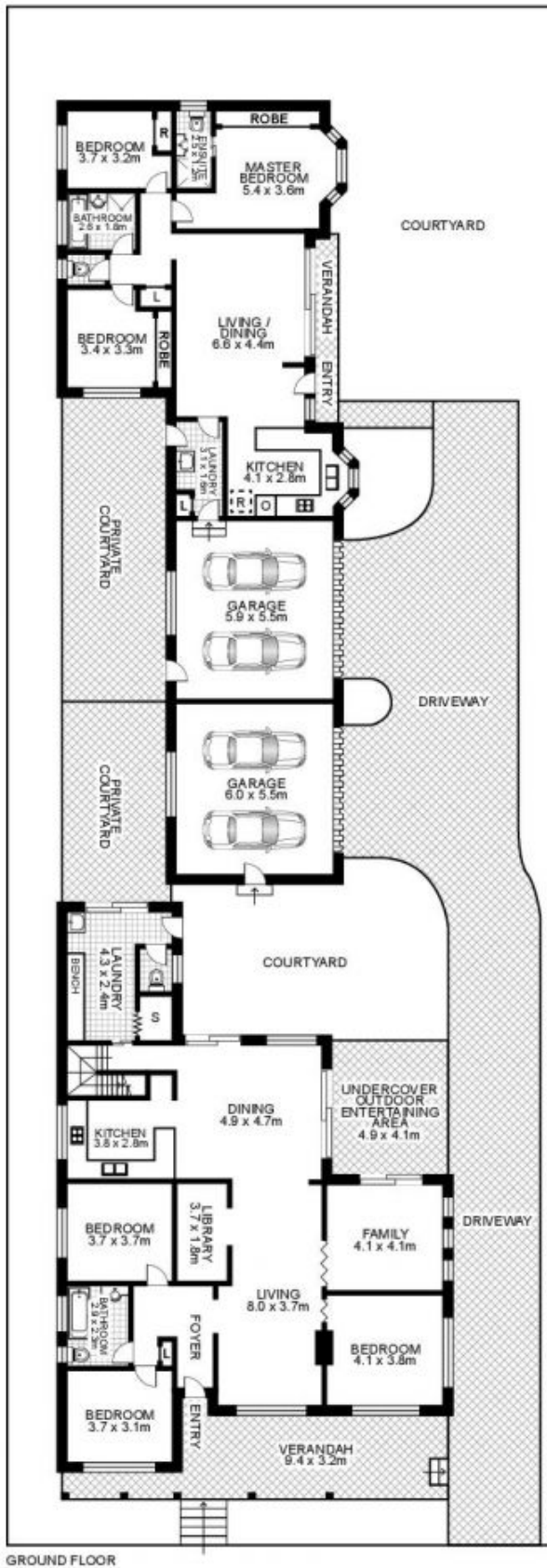

This floor plan is intended as a guide only. Layout dimension are approximate only. No representation or warranties of any nature whatsoever are given or intended. Any person using this information should rely on their own enquiries.

GUNNING