

GUNNING



Shop 1/259 Crown Street Surry Hills NSW

Strategically located on the corner of Crown and Goulburn Street.

Shop 1 features:

- Ground floor corner retail
- Amenities
- Partly fitted kitchen area
- Good natural light
- Excellent location with street exposure, neighbouring tenants include Grill'd burgers, KFC, Mad Mex and Rivareno Gelato.
- Close proximity to Oxford Street and restaurants
- Suitable for a wide range of uses (STCA) including hospitality, hair dresser, fashion etc.

Building Size : 76 sqm
Land Size : 76 sqm
View : <https://www.gunningre.com.au/lease/nsw/eastern-suburbs/surry-hills/commercial/retail/5731971>



Tushar Bakshi
02 9698 0222



Daniel Gunning
02 9698 0222

For more information or to inspect, please contact the

Shop 1 / 259 Crown Street, SURRY HILLS

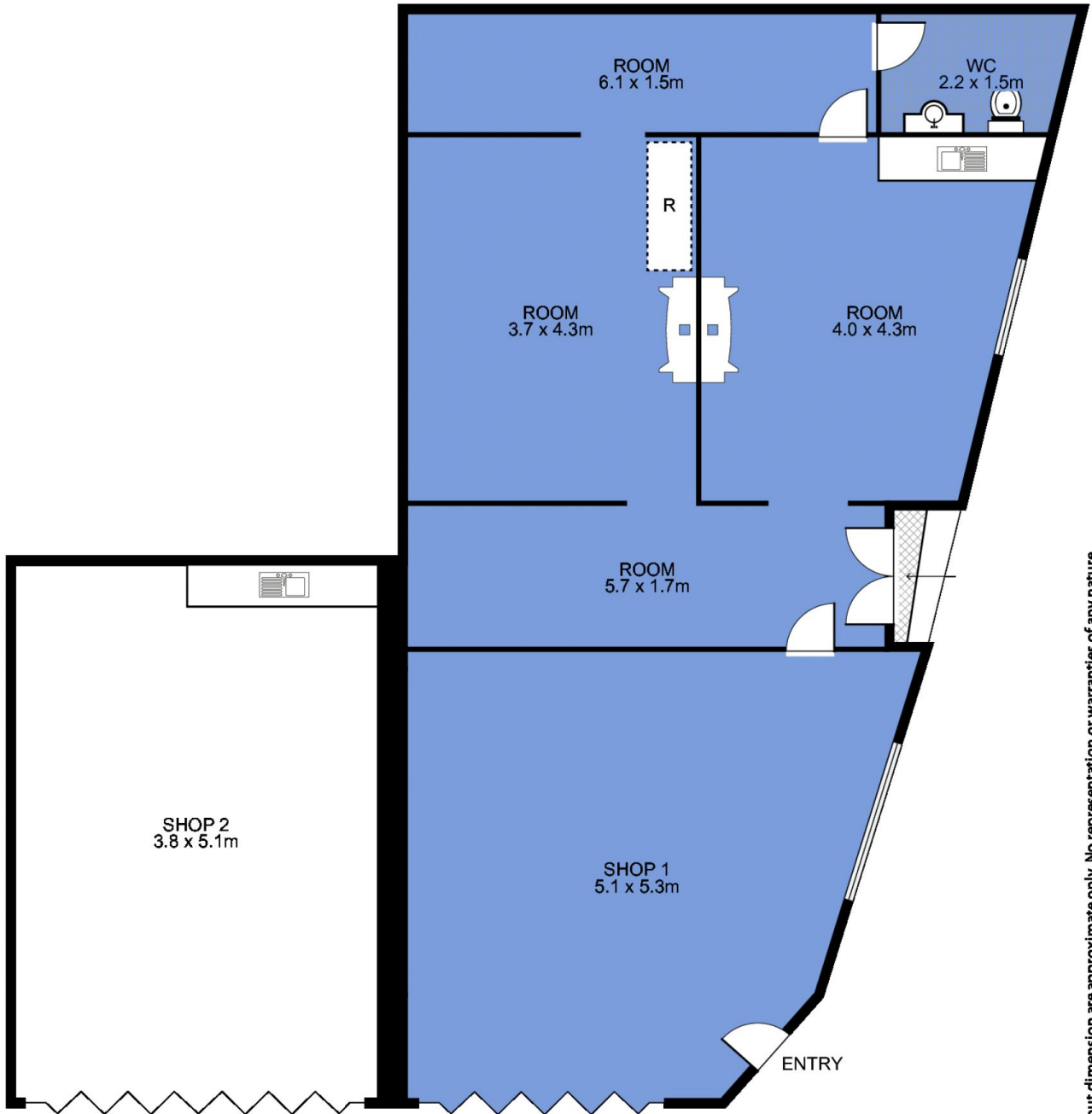

Approx. Shop 1 Area : 76m²

GUNNING



This floor plan is intended as a guide only. Layout dimension are approximate only. No representation or warranties of any nature whatsoever are given or intended. Any person using this information should rely on their own enquiries.